

THREE BEDROOMS



House - Semi-Detached (EPC Rating: C)

POPPY CLOSE, EVESHAM, WR11 3GA

£1,200 PCM

AVON
ESTATES
SALES & LETTINGS



3 Bedroom House - Semi-Detached located in Evesham

Nestled in the charming area of Poppy Close, Evesham, this delightful property offers a perfect blend of modern living and comfort. Built in 2015, the home spans an impressive 1,012 square feet, providing ample space for both relaxation and entertaining.

Upon entering, you are welcomed into a well-appointed reception room, ideal for hosting guests or enjoying quiet evenings at home. The property features three generously sized bedrooms, each designed to offer a peaceful retreat at the end of the day. The layout is thoughtfully designed to maximise space and light, creating a warm and inviting atmosphere throughout.

One of the standout features of this property is the convenient parking available for two vehicles, a rare find in many urban settings. This added benefit ensures that you and your guests will always have a place to park.

Available 26/12/2025

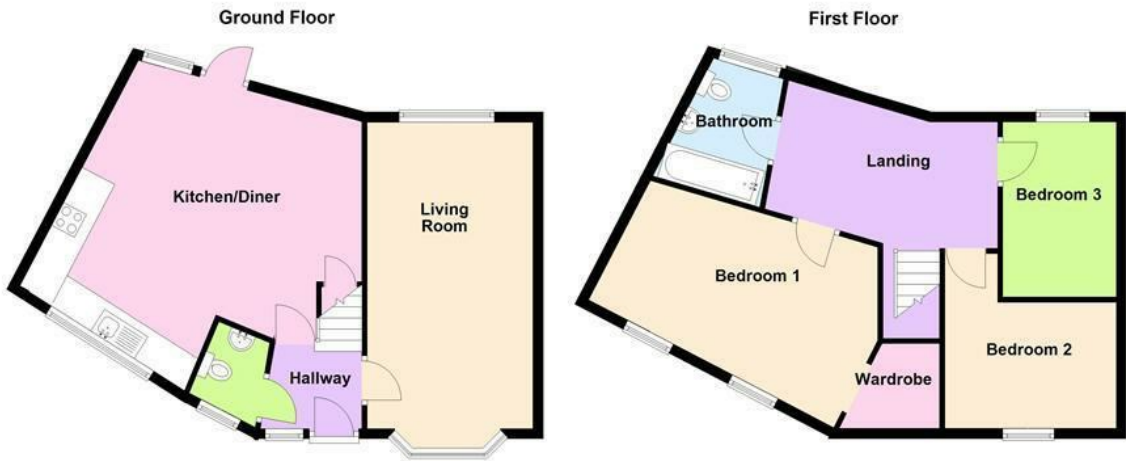

Council Tax Band
C
Energy Performance Graph

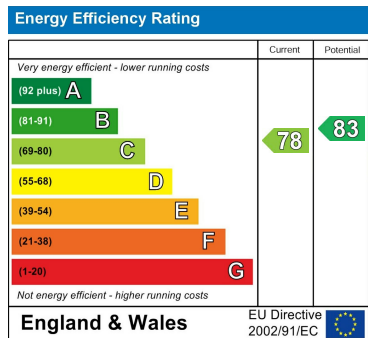

Call us on
01386 257180
lettings@avonestates.net
www.avonestates.net

Agents Note: Whilst every care has been taken to prepare these particulars, they are for guidance purposes only. All measurements are approximate and are for general guidance purposes only and whilst every care has been taken to ensure their accuracy, they should not be relied upon and potential buyers are advised to recheck the measurements.